

## Series LA 20 - Z (two material components)

for automatic transport of free flowing materials  
with bulk density of 0,4... 0,8 kg/Litre and max Temp. of 80 °C



LA 20 -Z - single phase motor

LA 20 -Z - 3 phase motor

### Standard features:

- ✓ electro polished stainless steel construction
- ✓ automatic filter cleaning
- ✓ microprocessor controlled conveying functions
- ✓ Control box 24VDC and power box in separate housings

### Options:

- clean our valve for product line
- alarm signal contact, alarm lamp

### Series LA 20 - Z

Model	Art. No.	Throughput *	Distance * horizontal/ vertical	Vacuum generator		Filter cleaning by	Supply Voltage	Weight
				integrated turbine	separate 3ph-blower			
LA 20-Z	1022.08	50 kg/h	15 m / 2 m	1100 W		Compressed Air	230V 50Hz	10 kg
LA 20-11-Z	1017.08	100 kg/h	20 m / 4 m		1,1 kW	Implosion	400V, 50Hz	36 kg
LA 20-15-Z	1018.08	100 kg/h	30 m / 4 m		1,5 kW			
LA 20-22-Z	1019.08	150 kg/h	30 m / 5 m		2,2 kW			
LA 20-30-Z	1020.08	200 kg/h	50 m / 5 m		3,0 kW			

\* Advice: the maximum values are depending on the individual products and may not all be reached at the same time

**Hopper loader LA 20- Z with single phase turbine**  
*for transportation of: free flowing granulated resins + regrinds*

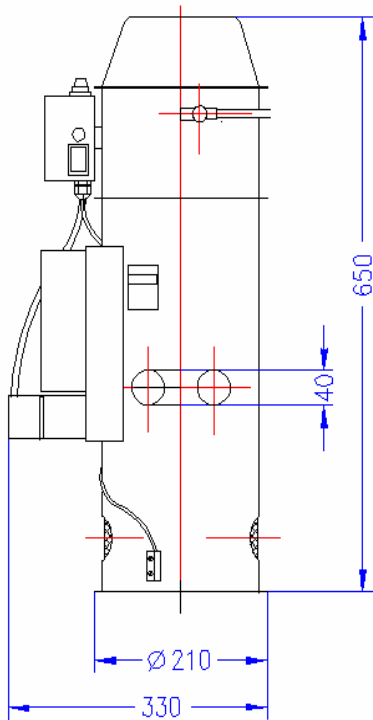

**Functions:** The turbine builds up an under pressure in the separator, the material outlet flap gets closed and in the material feed line a strong air stream is created. From the material pick up point a mixture of air and resin flows to the loader where the resin is separated by a filter from the incoming air. The product settles in the loader whilst the air is blown back to the atmosphere. The total conveying time is split in a part time for component 1 and another part time for component 2.

After the adjusted conveying times 1 and 2 ran out the turbine motor is switched off. Atmospheric air flows in the separator through the turbine so that the outlet flap can be opened by the gravity of the resin. The material filling can flow out now. A magnet fixed at the outlet flap operates a magnet switch in such a way that the contact of magnet switch is closed when the outlet flap can fall back again after the resin was released. This starts a new conveying cycle that begins with compressed air pulses for the filter cleaning. The loader is conveying material until the containment under the loader is filled up and the outlet flap remains in an open position hold by the resin still remaining in the separator.

**Loaders LA 20-Z with separate 3phase blower motors**  
*for transportation of: free flowing granulated resins + regrinds*

- Loaders with 3phase blowers 2,2kW and up can also
- be used for free flowing powders

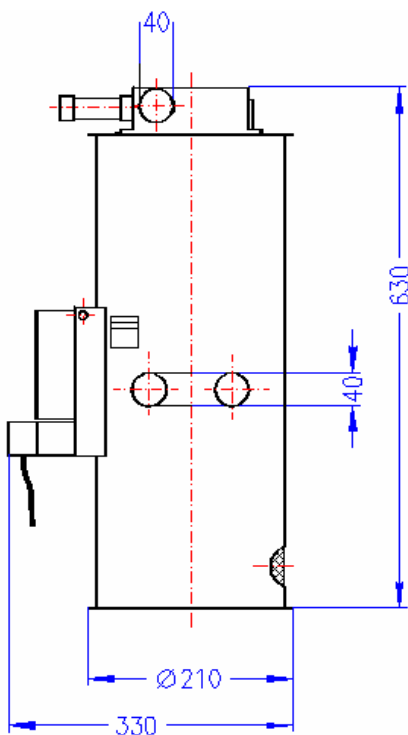

**Functions:** Each conveying cycle begins with a filter cleaning. The suction valve opens and the implosion inlet and material valves are closed. The outlet flap is sucked against the flap sealing. The loader body is partly evacuated to the max under pressure the blower can build up. Now the suction valve is released and the implosion inlet opened. Ambient air now flows in as strong air stream through the filter and cleans it from dust and particles. No dust will come out to the environment. In stand by position the material valves and the suction valve remain closed and the implosion inlet is open. During conveying the suction valve and the material valves one and two are open and the implosion inlet is closed. By the air stream created by the blower a mixture of air and resin flows from the pick up point into the separator. The granulates settle in the separator and the conveying air get sucked through the filter and is given back to the atmosphere at the air outlet opening of the blower motor. When the set conveying times ran out the blower motor is switched off, the suction valve and the product valves get closed and the implosion inlet is opened. The outlet flap now can open by the gravity of the resins and the materials can flow out. A magnet at the outlet flap operates a magnet switch and starts a new conveying cycle until the containment under the loader is filled up and the outlet flap remains in an open stand by position.

**Lanco GmbH**  
 Moselstrasse 56-58  
 D-63452 Hanau / Germany  
 Tel: +49 (0) 6181 91600 - 0  
 Fax: +49 (0) 6181 91600 - 40  
 www.lanco.de